



Instruction manual

Read carefully before use

CE  RoHS

1. Package Contents and Setup

Inside the package you will find Coverride and some accessories:

Coverride

With coloration chosen during purchase



Charger

20W with dual USB and USB Type C inputs



Charging cable

USB to Type C, for charging Coverride



Reset Pin

For the forced arrest of Coverride

Instruction manual

To insert the smartphone into the Coverride slot:



1
Insert the smartphone from the side bottom and make sure it is well wrapped by Coverride's TPU edge.

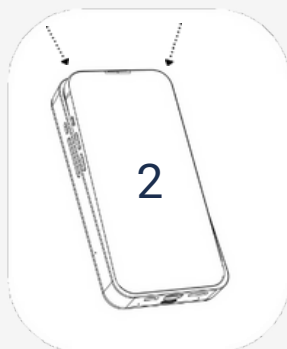

2
Apply light pressure to the upper left and right edges of the smartphone to slide it into the Coverride housing.



You have correctly inserted your smartphone, you are ready to enjoy all the benefits of Coverride.

To remove the smartphone from the Coverride housing:



1
Use thumb to widen Slightly the upper right edge of the housing.



2
Apply light pressure from the camera photo to lift the smartphone.

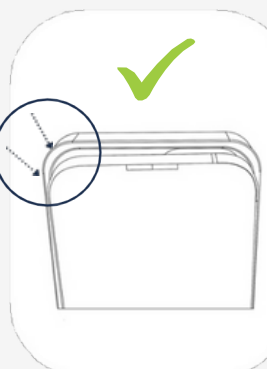

Repeat the process for the upper left edge and remove the smartphone.

INSTRUCTION MANUAL
always updated and improved



Coverride is a
product of
SEARCODE SRL

VAT NUMBER 03723130799

Registered office in
Magna Grecia Avenue
57 88100 Catanzaro
(CZ)

Customer Support
info@coverride.com

Made in Italy

2. Configuration of the official app

Thank you for purchasing Coverride, an exclusive, patented and made in Italy product from SEARCODE SRL.

First, install
the official
app
by Coverride

Frame the QR Code



Or

Click on the logo



Once you have downloaded and installed the official app on your smartphone, you will need to complete the setup wizard:

Step 1

When you first log in you will see the welcome screen (Fig. A), press "START" to begin configuration.



Fig. A - App Configuration Start

Step 2

Enter the serial number of your Coverride (Fig. B), you can find it on the back of the product box.

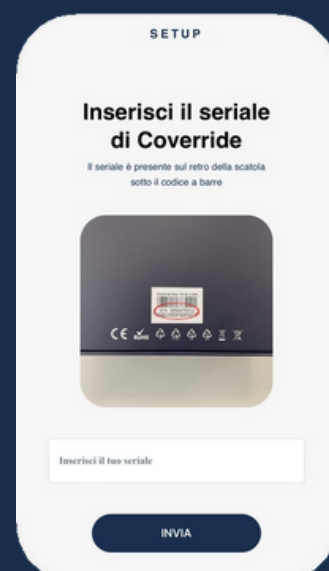

Fig. B - Serial

Step 3

Grant the necessary permissions to allow your smartphone to connect to Coverride.



Fig. C - Authorizations

Step 4

Create an account to access the app.

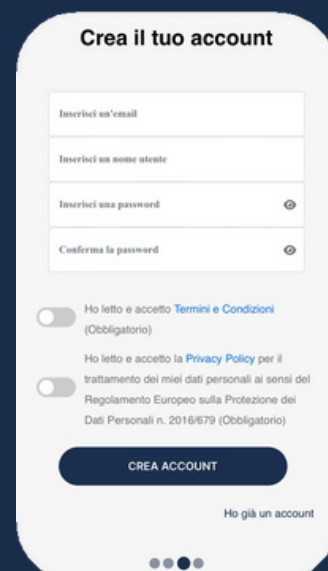

Fig. D - Create an account

Step 5

You have completed the process, now you can log in, download designs from the app or upload your own content and upload it to Coverride.



Fig. E - Configuration completed

3. First use of Coverride

To start using your new Coverride, it is essential to familiarize yourself with the physical controls located on the left side (Fig. F). You will find here two key buttons that allow you to manage the main functions of the coverride:

- **On/Off button (top):** This button is used to turn your Coverride on and off. To turn it on, press and hold the button for about 3 seconds until the logo appears on the display. To turn it off, repeat the same operation. When Coverride is on, by quickly pressing this button 1 time only, you can display the remaining percentage of battery charge.
- **Access Point button (bottom):** When Coverride is on, pressing once activates the access point mode that allows your smartphone to connect to Coverride over WiFi for transferring and editing designs.

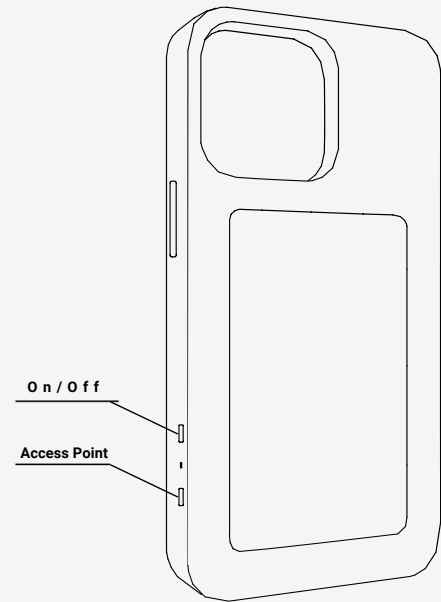
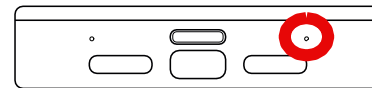

Fig. F - Left Side

Reset button



The reset button is located inside the hole to the right of the Type C charging input. This button is useful for Carry out the forced shutdown of Coverride.

Using Reset

Insert the reset pin slightly tilted upward and push it forward. As soon as you hear the button pressed, the forced shutdown will take place.

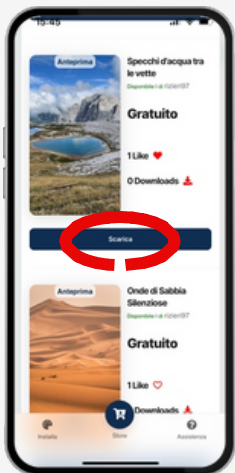

Fig. G - Download a design



Fig. H - Upload a design



Fig. I - Authentication code

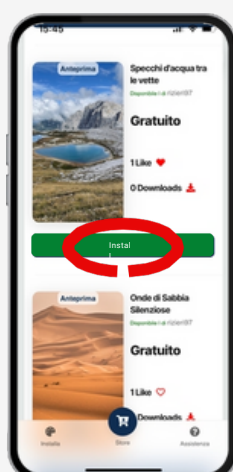

Fig. L - Install

4. How to change the design of Coverride

- Turn on Coverride by holding down the On/Off button (Fig. F) for 3 seconds and wait until it is fully turned on; it will take a few seconds.
- Login to the official app, then download a design (fig. G) or upload a media content from the gallery (fig. H).
- Take your Coverride, already lit, then press a time the Access Point button (Fig. F) and wait for the "Authentication Code" to appear (Fig. I).
- Go back to the App and hit "Install" under the design you had previously downloaded (Fig. L). Wait for the process to complete.
- Take your Coverride and press the button once of Access Point (Fig. F) to exit the upload mode.
- Wait until the new design is shown on your Coverride and enjoy it!

5. Questions and Troubleshooting

- **Coverride does not turn on**

If it does not turn on, make sure Coverride is charged, then from off, try attaching it to the charger and see if it starts charging. If it is not discharged, make sure it is not in a preemptive lockout situation (in a darkened environment, you will observe the display slightly backlit), in which case press the reset button with the appropriate pin and then try turning it on.

- **I can't change the design**

To change designs, you must follow the instructions in Chapter 4 (page 5) of this manual carefully and in order. In addition, enabling guided installation from your profile within the app allows you to have a full reminder of the installation process at your fingertips. If you turn on the Access Point on your Coverride before downloading the design, your smartphone may automatically connect to Coverride and lose its internet connection, preventing you from downloading the design, which is why it is critical to follow the process in the correct order.

- **I can't load some content from the gallery on the App**

Most media content can be uploaded to the App and installed on Coverride, however consider that uncommon formats or excessive size (>80mb) may generate blockages. We recommend using classic formats such as MP4, MOV, JPG, PNG.

- **After loading a new design, the display shows one of the following messages, "File Decode Error" / "Invalid File" / "Invalid File Error"**

Sometimes it may happen that the connection between your smartphone and Coverride is broken while uploading a new design; these are normal situations. If this happens, the file will be corrupted and therefore Coverride will not be able to process it. Unusual formats can also cause unexpected errors. If you are using common formats, it will be sufficient to re-upload the media content to fix the problem.

- **I can't update the design if the smartphone is in airplane mode**

If you are in airplane mode, the iPhone will not always be able to communicate properly with Coverride, and in some cases you may not be able to send the new design. If this happens, try restarting the App and Coverride and try again. If the problem persists, exit airplane mode and the problem will be solved.

- **Battery life is short**

It is critical to preserve the battery with proper use and practices, both for safety and performance issues. On the following pages are some very important pointers for battery use. If the battery life has decreased compared to the past, it is likely that it has been used/charged incorrectly, so it would be wise to replace it by contacting our customer service department. Batteries are assets that normally tend to deteriorate over time, even with proper use. It is recommended to leave the device on charge for about 30 minutes longer after reaching 100% shown on the display, this will allow the battery to reach its maximum range.

- **Coverride does not respond to commands**

Rarely, Coverride may freeze if it encounters environmental conditions or special situations that could damage it, generally in these cases it will continue to play the design but you will not be able to enter the "Access Point" mode or turn it off. To solve the problem, simply press the reset button through the pin provided or wait for it to discharge and turn itself off.

- **I lost the serial number of my Coverride**

If you think you have misplaced the serial, please contact us at info@coverride.com and our customer support will assist you to retrieve it.

- **I can't insert/remove the smartphone**

To insert or remove the smartphone, it is essential to follow the Setup directions in Chapter 1 (p. 2) of this manual. Failure to follow the requirements in the manual may result in damage to Coverride or the smartphone.

- **After a heavy fall, it seems that my Coverride rises slightly from the sides**

Coverride is sealed with high-performance adhesives produced by 3M and Tesa, the market leader in bonding solution. The product is designed to withstand impact through a firm, high-strength seal; however, in the event of a very strong impact, the side edges of the product may rise slightly. This is a normal and expected situation, you will only need to apply light pressure with your hands for 20 to 30 seconds to the affected part and the product will be sealed again.

- **App crashes during use**

In some cases, such as in the absence of a stable internet connection, the Coverride App may be slow or freeze frequently. We recommend restarting the Smartphone and the App, as well as connecting to a stable network. Using a stable network is critical for smooth operation. Should problems persist, contact our customer support at info@coverride.com

Haven't you solved the problem?

Contact us at info@coverride.com

To receive assistance from our customer support.



Technical directions & safety

Read carefully before use

CE  RoHS

Coverride is a patented product designed by SEARCODE SRL, an Italian company specializing in innovative technologies. The product complies with CE and RoHS regulations, and laboratory tests were conducted by Sicom Test srl a single member, located in San Canzian d'Isonzo (GO), Italy.

6. Coverride Components

The package contains Coverride, an assembled product consisting of several components, including:

- Plastic shell i.e. polycarbonate hard part, TPU flexible part; 1,900 mAh lithium-ion battery;
- PCBA (Electronic board) equipped with Wireless chip; LCD display in 3.97" or 4" format;
- 20W charger with dual USB and USB Type-C output; USB to USB Type-C charging cable;
- Reset Pin and Instruction Manual.

7. Finishes on plastic

The finishes on Coverride's plastic shell are printed through UV printing technology with inks that meet the safety requirements of current regulations. This printing method has a significant impact in the cover industry, allowing for glossy and embossed effects that give an exceptional aesthetic appearance. Because of its ability to cure or cure inks through exposure to ultraviolet light, detailed, vivid, high-definition finishes can be created. Finishes created through UV printing are extremely strong and durable. UV inks adhere firmly to the surface of the plastic, providing effective protection against scratching, fading and discoloration over time. This ensures that Coverride can maintain its long-term beauty and aesthetic integrity, even with daily use. Inks can cause irritation if the person who comes into contact with them has allergies or related conditions, so it is important to stop using the product immediately if there is the presumption elements to establish the incompatibility of the ink with the subject's skin.

8. Exposure to radio frequency electromagnetic fields

Coverride uses WiFi and acts as an access point, transmitting radiofrequency signals to enable connection with external devices. Exposure to radiofrequency energy is an important issue to consider, as there are regulations and guidelines that establish exposure limits to ensure the safety of users. Health effects from exposure to radiofrequency energy are being studied and monitored continuously by health organizations and institutes around the world. However, it is important to note that Coverride is designed and manufactured in compliance with all applicable safety and exposure limit requirements and regulations. Regulations and guidelines set maximum allowable exposure values for several parameters, such as specific absorption rate (SAR), which measures the amount of energy absorbed by the human body during the use of radiofrequency devices. Coverride has been designed to comply with these reference values and recorded parameters, including maximum values for each parameter, which comply with current regulations. This means that Coverride has been carefully tested and certified to ensure that exposure to energy at

radio frequency is within the established safety limits. Users can therefore use the product in accordance with the guidelines provided without concern for their health. However, it is always advisable to follow normal precautions for use of electronic devices, such as avoiding excessive or prolonged use and keeping the product at an appropriate distance from the body during use. If you have any further questions or concerns regarding RF energy exposure, please consult the information and resources provided by the relevant health authorities and the European Union-Institute of Health: <https://www.epicentro.iss.it/campi-elettromagnetici/epidemiologia>

9. Guidelines for rechargeable battery use.

Proper charging of Coverride's battery is essential to optimize performance and extend battery life. Coverride is equipped with a lithium-ion battery, a common technology used in many portable electronic devices. Below are some general guidelines for proper charging of the device:

- **Battery replacement:** Replacing the battery with one not of the same type can lead to dangerous situations. It is recommended to use only original or compatible batteries supplied by the manufacturer.
- **Explosion hazard:** Do not throw the battery into a fire, expose it to high temperatures such as in a hot oven, or crush or cut it mechanically. These actions can cause an explosion.
- **Temperature extremes:** Leaving the battery in an extremely high temperature environment can lead to the battery exploding or flammable liquid or gas escaping.
- **Atmospheric pressure:** If the battery is subjected to extremely low atmospheric pressure, it could cause an explosion or the escape of flammable liquids or gases.
- **Charging Conditions:** Charging the battery should be done at a temperature range of -10 °C to +43 °C. Charging the battery outside this temperature range may compromise its safety and durability.
- **Charging from off:** It is advisable to turn Coverride off during the charging phase. This helps to ensure more efficient charging and optimal battery life.
- **Using a compatible charger:** Make sure to use a Coverride-compatible charger that can provide the correct charging power. Use of inappropriate or non-genuine chargers may adversely affect charging and battery life.
- **Charge status monitoring:** While charging, Coverride shows the current charge status on the display. The charging status is shown in steps: 0%, 20%, 25%, 50%, 75% or 100%. You can monitor charging progress through these values.
- **Battery life:** Coverride's battery life varies with usage conditions. Under controlled conditions, the battery can last up to 9 consecutive hours, while under normal use conditions it offers an average battery life of 6-8 hours. It is important to keep in mind that running complex multimedia content can reduce overall battery life.

10. **Legal guarantee in EU**

Coverride is covered by a 2-year legal warranty in the EU. This warranty covers defects in workmanship and conformity. If Coverride has a defect within 2 years of purchase, you can request a free repair or replacement. The warranty does not cover damage accidental or caused by improper use of the product. Follow the manufacturer's instructions for seeking warranty or out-of-warranty technical support through the product app, "Service" section > "Warranty Request." Keep your proof of purchase. For more information, contact customer service.

11. **Product Disposal (WEEE)**

Coverride falls under the WEEE (Waste Electrical and Electronic Equipment) regulations, which means it is important to follow proper disposal procedures when the product reaches the end of its life cycle. Do not throw Coverride in general household waste. You must properly dispose of the product at the dedicated collection points for e-waste in your country or area. This ensures that the product is handled responsibly, reducing the impact on the environment and allowing materials to be recycled properly. Remember that the Proper disposal of electronic products helps to preserve the environment and reduce negative impacts on human health.

12. **Made in Italy**

Coverride is a proudly "Made in Italy" product that complies with current customs classification regulations. This means that Coverride was designed, developed and assembled at SEARCODE SRL's facility in Catanzaro, Italy. The "Made in Italy" mark is an important indication of internationally recognized quality, craftsmanship and design. The assembly of Coverride in Italy guarantees strict control over product quality and adherence to high production standards. Every stage of Coverride's production, from design to manufacture, is handled with care and attention to deliver a safe, reliable and high-quality product. The use of durable materials and precision assembly ensure long life and optimal product performance. By choosing Coverride, you also support Italian industry and help preserve the craftsmanship and excellence of made in Italy.

13. **Technical support and troubleshooting**

To solve any problems with Coverride, you can contact our customer service department via website chat or email (info@coverride.com). In case of display errors, such as "Invalid input file," follow the instructions in the "Support" > "FAQ" section of the app Official to resolve them quickly. We are here to offer you support and ensure a pleasant experience with Coverride.

© Coverride is the exclusive property of SEARCODE SRL. All rights are reserved. Unauthorized reproduction, distribution or use of the Coverride trademark or its contents without prior written consent from SEARCODE SRL is prohibited. Any unauthorized use of the Coverride trademark constitutes a violation of the property rights intellectual and will be prosecuted according to applicable laws.

EU DECLARATION OF CONFORMITY

Product

Coverride - Coverride One

Manufacturer or its authorized representative

Searcode Ltd.

Via Magna Grecia, 57

Catanzaro CZ

88100

Italy

This declaration of conformity is issued under the sole responsibility of the manufacturer.

Object of the declaration:

Electronic case for smartphone (cover)

Brand: Coverride

Model: Coverride One



The object of the declaration described above is in conformity with the relevant Union harmonization legislation:

- **2014/53/EU** on the harmonization of the laws of the Member States relating to the making available on the market of radio equipment and repealing Directive 1999/5/EC.

1999/519/EC on the limitation of exposure of the general public to electromagnetic fields.

References to the relevant harmonized standards used or references to the other technical specifications in relation to which conformity is declared:

EN 300 328 V2.2.2 Wideband transmission systems; Data transmission equipment operating in the 2,4 GHz ISM band and using wide band modulation techniques; Harmonised Standard covering the essential requirements of article 3.2 of Directive 2014/53/EU

EN 301 489-1 V2.2.3 Electromagnetic compatibility and Radio spectrum Matters (ERM); ElectroMagnetic Compatibility (EMC) standard for radio equipment and services; Part 1: Common technical requirements

EN 301 489-17 V3.2.4 Electromagnetic compatibility and Radio spectrum Matters (ERM); ElectroMagnetic Compatibility (EMC) standard for radio equipment; Part 17: Specific conditions for Broadband Data Transmission Systems

EN 62368-1:2020 + A11:2020 Audio/video, information and communication technology equipment - Part 1: Safety requirements

EN 62479:2010 Assessment of the compliance of low power electronic and electrical equipment with the basic restrictions related to human exposure to electromagnetic fields (10 MHz to 300 GHz)

Signed for and on behalf of: Searcode Srl

Catanzaro, 05/06/2024

Rizieri Mele, CEO

 **SEARCODE S.R.L.**
RIZIERI MELE
Viale Magna Grecia 57 - 88100 Catanzaro
P.IVÁ 03723130799 - REA CZ2099021
Tel. +39096522035 - Email: r.mele@searcode.com

EU DECLARATION OF CONFORMITY

Product

Coverride - Coverride One Élite

Manufacturer or its authorized representative

Searcode Ltd.

Via Magna Grecia, 57

Catanzaro CZ

88100

Italy

This declaration of conformity is issued under the sole responsibility of the manufacturer.

Object of the declaration:

Electronic case for smartphone (cover)

Brand: Coverride

Model: Coverride One Élite



The object of the declaration described above is in conformity with the relevant Union harmonization legislation:

- **2014/53/EU** on the harmonization of the laws of the Member States relating to the making available on the market of radio equipment and repealing Directive 1999/5/EC.
- **1999/519/EC** on the limitation of exposure of the general public to electromagnetic fields.

References to the relevant harmonized standards used or references to the other technical specifications in relation to which conformity is declared:

EN 300 328 V2.2.2 Wideband transmission systems; Data transmission equipment operating in the 2,4 GHz ISM band and using wide band modulation techniques; Harmonised Standard covering the essential requirements of article 3.2 of Directive 2014/53/EU

EN 301 489-1 V2.2.3 Electromagnetic compatibility and Radio spectrum Matters (ERM); ElectroMagnetic Compatibility (EMC) standard for radio equipment and services; Part 1: Common technical requirements

EN 301 489-17 V3.2.4 Electromagnetic compatibility and Radio spectrum Matters (ERM); ElectroMagnetic Compatibility (EMC) standard for radio equipment; Part 17: Specific conditions for Broadband Data Transmission Systems

EN 62368-1:2020 + A11:2020 Audio/video, information and communication technology equipment - Part 1: Safety requirements

EN 62479:2010 Assessment of the compliance of low power electronic and electrical equipment with the basic restrictions related to human exposure to electromagnetic fields (10 MHz to 300 GHz)

Signed for and on behalf of: Searcode Srl

Catanzaro, 05/06/2024

Rizieri Mele, CEO

